

## DIN 436 Square Washers

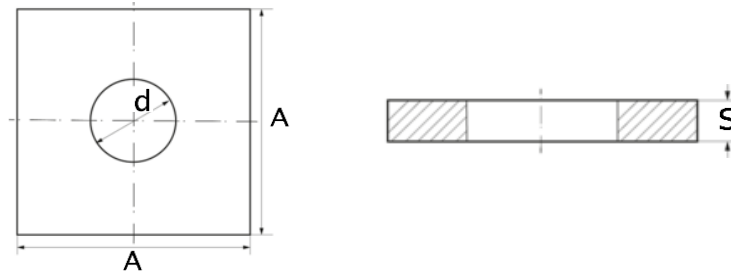

DIN 436 Square Washers					
Size	M10	M12	M16	M20	M22
d	11.0	13.5	17.5	22.00	24.0
A	30	40	50	60	70
S	3	4	5	5	6

General Tolerance: +/- 0.3mm

Material: Natural Nylon

INFORMATION AND DRAWINGS PROVIDED ARE FOR  
REFERENCE ONLY